

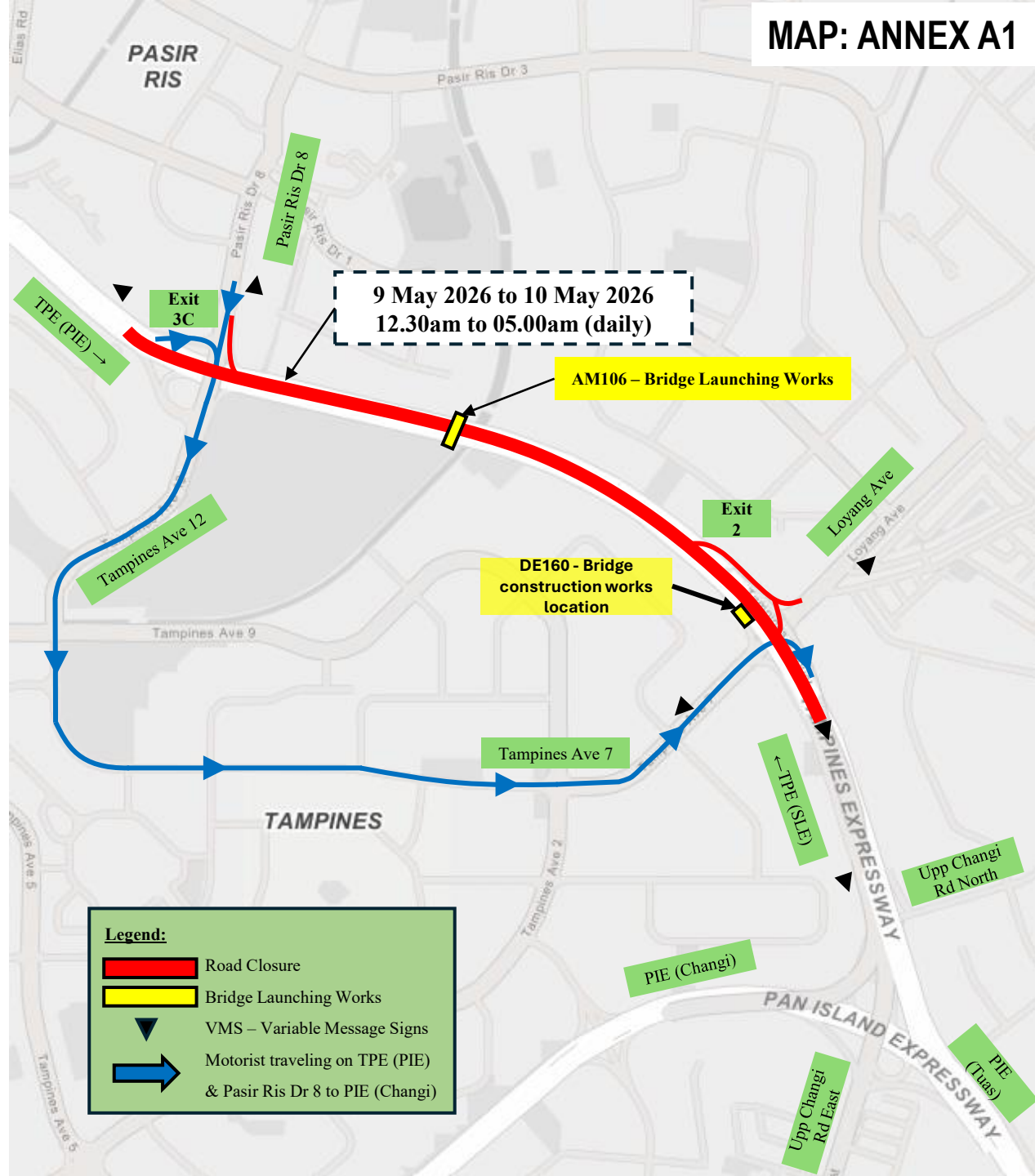



Location	Closure Date	Alternative Route
TPE(PIE) after Exit 3C to Exit 2, Slip Road from Pasir Ris Dr 8 to TPE(PIE)	9 May 2026 to 10 May 2026 12.30am to 5.00am (daily)	<p>Motorists travelling from TPE(PIE) heading towards PIE(Changi), PIE (Tuas) and Upp Changi Rd East can take Exit 3C heading towards Tampines Ave 12 and onto Tampines Ave 7 until Loyang Ave, before turning right back onto TPE(PIE).</p> <p>Motorists travelling from Pasir Ris Dr 8 heading towards PIE(Changi), PIE(Tuas) and Upp Changi Rd East can head towards Tampines Ave 12 and onto Tampines Ave 7 until Loyang Ave, before turning right back onto the TPE(PIE).</p> <p>Refer to Annex A1</p>
TPE (SLE) after Exit 2 to Exit 3B	9 May 2026 to 10 May 2026 1.00am to 5.00am (daily)	<p>Motorists travelling from PIE(Changi), PIE(Tuas), Upp Changi Rd North and Upp Changi Rd East heading towards TPE(SLE) can take Exit 2 heading towards Tampines Ave 7 onto Tampines Ave 12 before turning left back onto TPE(SLE).</p> <p>Refer to Annex A2</p>
Slip road entering TPE (SLE) via Loyang Ave and Tampines Ave 7	8 May 2026 to 9 May 2026 10.00pm to 5.30am (daily) and till 10 May 2026,5.30am	<p>Motorists travelling from Tampines Ave 7 heading towards TPE(SLE) can head towards Loyang Ave, to Pasir Ris Dr 3 and onto Pasir Ris Dr 8 until after Pasir Ris Flyover.</p> <p>Motorist travelling from Loyang Ave heading towards TPE(SLE) can head towards Tampines Ave 7 onto Tampines Ave 12 before turning left onto TPE(SLE).</p> <p>Refer to Annex A2</p>

MAP: ANNEX A1



Legend:

-  Road Closure
-  Bridge Launching Works
-  VMS - Variable Message Signs
-  Motorist traveling on TPE (PIE) & Pasir Ris Dr 8 to PIE (Changi)

MAP: ANNEX A2

